

# SwabCap®

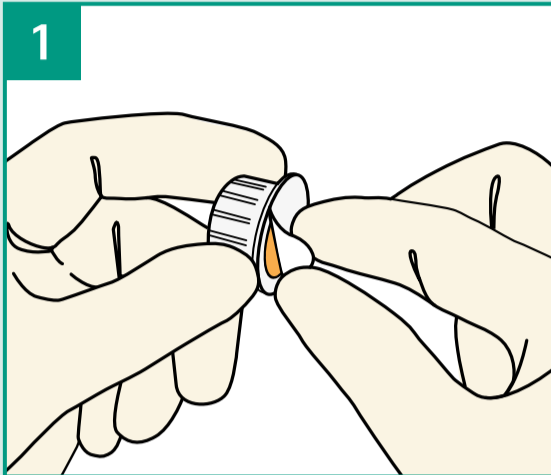

## Peel.

Use aseptically according to the manufacturer's instructions for use. Remove protective cover by pulling tab. Do not remove **SwabCap®** from white plastic holder.

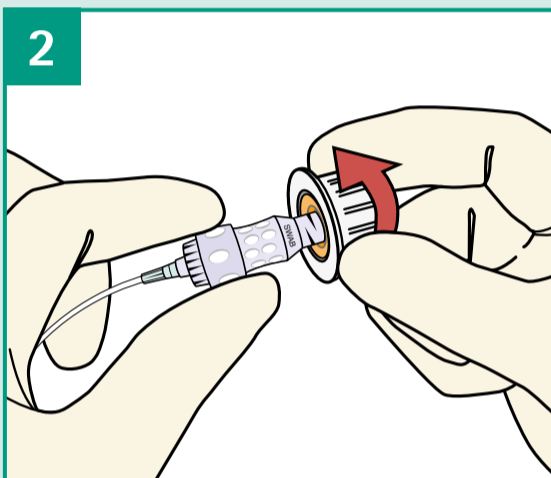

## Push & Twist.

Hold needleless swabbable valve in one hand while pushing and twisting the **SwabCap®** in a clockwise direction onto the valve.

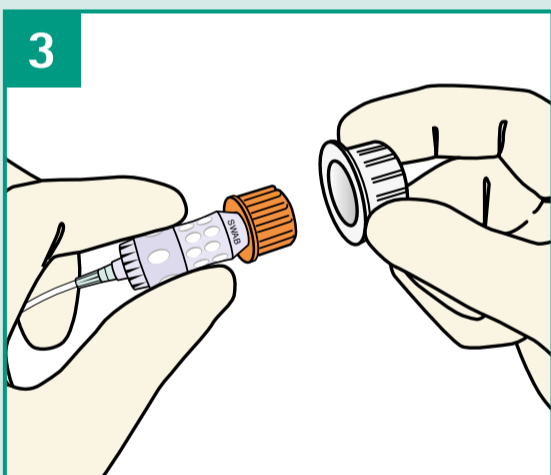

## Protect.

After **SwabCap®** has been twisted into place, gently pull white plastic holder straight off needleless swabbable valve.

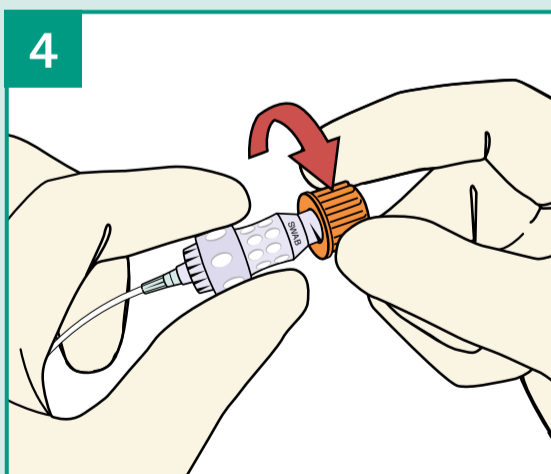

## To Remove for access to valve

Two-handed removal must be used to make sure needleless swabbable valve is not removed unintentionally.

Grasp valve and twist **SwabCap®** counter clockwise away from valve. Remove and discard.

**FOR SINGLE USE ONLY.**

Inspect valve to verify that it's connected securely to the catheter. Valve is ready for access.

Upon **SwabCap®** removal, no additional disinfection is necessary for valve access.



Luer Access Valve Cap with 70% Isopropyl alcohol (IPA) as a disinfectant. For use on needleless swabbable valves as a disinfecting cleaner prior to line access and as a physical barrier to contamination between line accesses. **SwabCap®** will disinfect the valve 5 minutes after application and maintains a disinfected valve surface for up to 7 days if not removed.

## Benefits for you

- Simplified and standardized disinfection technique saves nursing time
- Easier compliance with disinfection guidelines

## Benefits for your patient

- Passive, continuous disinfection of valve's top and threads
- Protection from touch and airborne contamination
- Disinfection compliance is visual and measurable

**B | BRAUN**  
SHARING EXPERTISE